

Section 6

MARINE ANTENNAS

Updated 21 February 2011

B20G-N-AMFM AM/FM Radio Receive Mast Mount or Side Mount

Frequency
530 KHz – 108 MHz

Bandwidth
AM and FM Radio



To boost AM and FM radio reception while at sea, the B20G-N-AMFM ground independent mast mount antenna offers superb performance. Alternatively, it can be side mounted from a wheelhouse or some other flat vertical surface.

The white fibreglass tapered radome and stainless steel mount tube stands 3.4 metres tall. An N-female connector is located at the base of the mount tube.

All components used in construction are of the highest quality to ensure the antenna will survive in the harsh marine environment for many years.

The B20G-N mast mount model for VHF 156 to 162 MHz is identical in appearance.

Mounting clamps, feeder cable, connectors, cable ties and tape are available separately to complete the installation.

SPECIFICATIONS	B20G-N-AMFM
Construction	Single piece white fibreglass radome, stainless steel mount tube
Frequency	AM Radio 530–1600 KHz, FM Radio 88–108 MHz
Tuning	Factory
Gain	Receive Only
Impedance	50 Ohms
Polarisation	Vertical
H-Plane	360° Omnidirectional
Cable	None supplied, available separately
Connector	N-female at base of mount tube
Height	3.4 metres
Weight	1.5 kg
Mount Tube Dimensions	500 mm long x 32 mm diameter
MAST Mounting Clamps (not supplied)	2 x EB1SS stainless steel parallel clamps recommended, suit round mast between 20 mm and 50 mm in diameter
SIDE Mounting Clamps (not supplied)	2 x NSM-CL3642 will suit the 32 mm mount tube

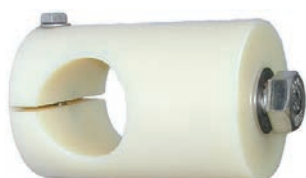

NSM-CL3642

Constructed from nylon with stainless steel bolts and washers, Nylon Side Mounts are specifically designed to mount a marine antenna to the side of a vessel's wheel house or other flat vertical structure.

Drill a 12.7 mm (1/2") diameter hole through the vertical surface for the stainless steel bolt. Then tighten the bolt to firmly secure the side mount in position.

Using two (2) of these nylon side mounts, the antenna mount tube is held tightly by the 8 mm stainless steel clamp bolt.

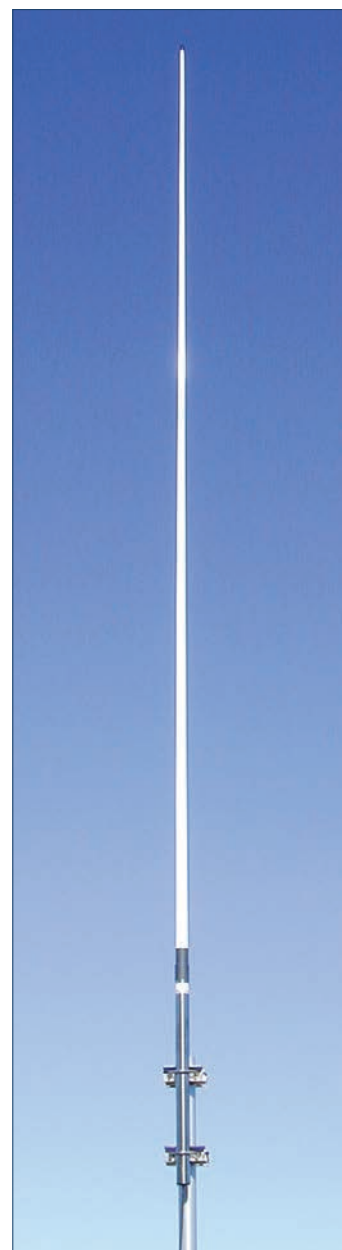

EB1SS
stainless steel
parallel mast
clamps