

Section 6

MARINE ANTENNAS

Updated 10 August 2011

ZM108A 27.88 MHz Marine Radio Mast Mount or Side Mount



ZM108A is a ground independent mast mount antenna for 27.88 MHz marine radio communications. This model can also be side mounted from a wheelhouse or any other flat vertical surface.

The white fibreglass radome and stainless steel mount tube stands 2.8 metres tall. The internal radiator is copper and the end fed half wave design provides excellent performance.

An N-Female connector is located at the base of the stainless steel mount tube. The maximum input power is 25 watts.

All components used are of the highest quality to ensure long term survival in the harsh marine environment. The antenna will deliver reliable performance for many years.

Mounting clamps, feeder cable, connectors, cable ties and tape are available separately to complete the installation.

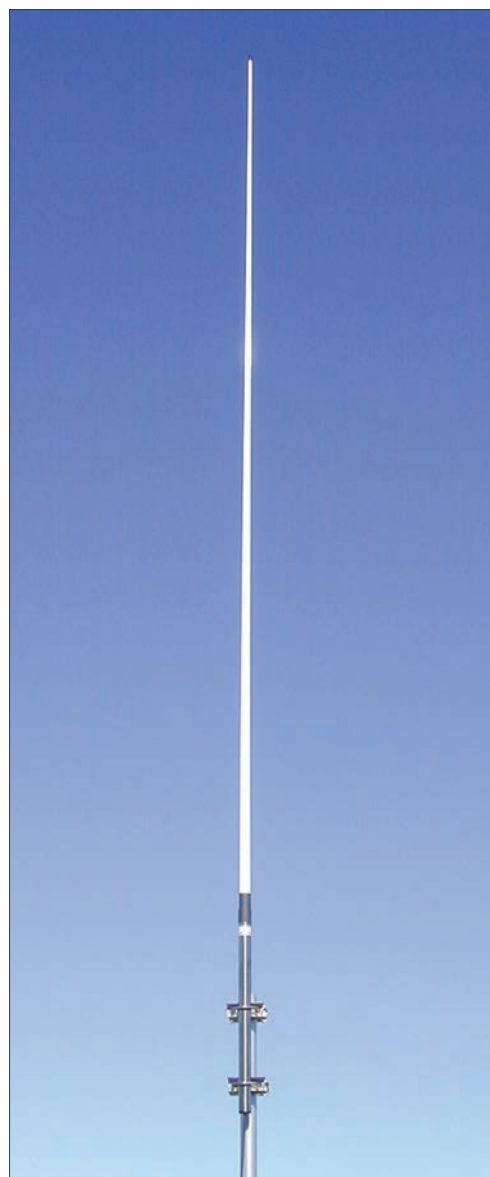

SPECIFICATIONS	ZM108A
Construction	Single piece white fibreglass tapered radome, copper radiator, stainless steel mount tube
Frequency	27.88 MHz Marine Radio
Tuning	Factory
VSWR	Better than 1.5:1
Gain	2.1 dBi
Max Input Power	25 Watts
Impedance	50 Ohms
Polarisation	Vertical
H-Plane	360° Omnidirectional
Connector	N-Female at base of mount tube
Height	2.8 metres
Weight	1.6 kg
Mount Tube	500 mm long x 22 mm diameter
MAST Mounting Clamps <i>(Not supplied, order separate)</i>	2 x EB1SS stainless steel parallel clamps are recommended. Suit round mast between 20 mm and 50 mm in diameter.
SIDE Mounting Clamps <i>(Not supplied, order separate)</i>	2 x NSM-B20M nylon side mounts are recommended to suit the 20 mm diameter mount tube.

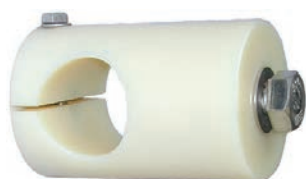

NSM-B20M

Constructed from nylon with stainless steel bolts and washers, Nylon Side Mounts are specifically designed to mount a marine antenna to the side of a vessel's wheel house or other flat vertical structure.

Drill a 12.7 mm (1/2") diameter hole through the vertical surface for the stainless steel bolt. Then tighten the bolt to firmly secure the side mount in position.

Using two (2) of these nylon side mounts, the antenna mount tube is held tight by the 8 mm stainless steel clamp bolt.



EB1SS
stainless steel
parallel mast
clamps